

T - 2938 - CDW-72 WELDING MACHINE



General description

The welding machine (CDW-72) allows the fixing of insulation material on sheet metal such as airducts in a single operation.

The CDW-72 ensures a high quality of weld on sheet metal up to a thickness of several centimeters. Due to long cables and light weight, this machine is useful for jobsite. This machine uses the capacitor discharge technique and allows clips to be welded without overheating mark on the opposite side of metal sheet.

It is recommended to use our weldfasteners CDF with our welding machine CDW-72.

The welding machine is available with or without a yellow or red carrying case.



Technical specifications

CAPACITANCE	66 000 µF
POWER SUPPLY	110 or 220 Volts / 50 or 60 Hz
INSULATION PROTECTION	IP 33
LOADING TIME	+/- 3 sec. according to the voltage used
WELDING RATE	Up to 20 pins / minute
LENGTH OF THE PISTOL CABLE	10 m
LENGTH OF THE EARTH / GROUND CABLE	5 m
WEIGHT OF THE UNIT WITHOUT CABLES	6,9 kg
WEIGHT OF THE UNIT WITH CABLES	11,4 kg
SIZE OF THE UNIT	295 x 155 x 220 with handle
WEIGHT OF THE CASE	4,7 kg
SIZE OF THE CASE	530 x 390 x 330 mm

CE Welding machine in accordance with European Unions norms and directives.

Welding pins SP2-TC, SP2-ER, SP3-ER and studs made out of steel, stainless steel or aluminum can be welded with this unit provided it is fitted with a contact gun (K-PCP-72) or gap gun (G-PCP-72) and the corresponding adapter.

Application

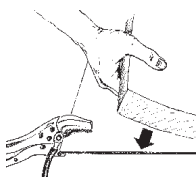

Fix earth / ground clamp of the welder to the sheet metal.
Lay insulation on sheet metal.



Place the weldfastener CDF on the magnetic head of the gun.
Adjust the voltage according to the type and thickness of the sheet metal.

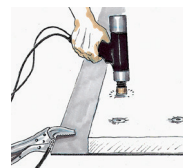

Press the pin through the insulation until the point meets the sheet metal and press the trigger.

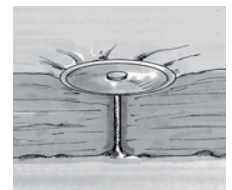

Information contained herein is based on careful tests and experience. It reflects our knowledge and is for guidance purpose only. It is given in good faith and user should ensure that the product is fit for purpose before any application. The quoted values are average and should not be taken as maximum or minimum values for specific purposes. Manufacturer and distributor are not responsible for any non-recommended use or consequential damage.

2016.03.03